

Honeywell

 DC515 XX P2/BS

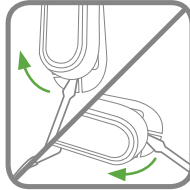
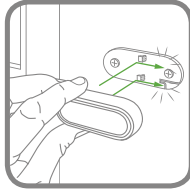
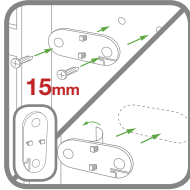
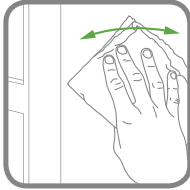
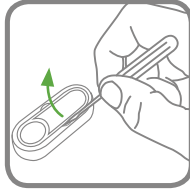
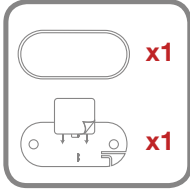
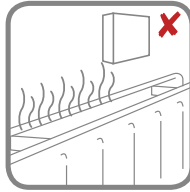
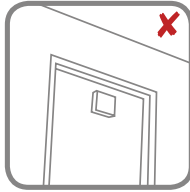
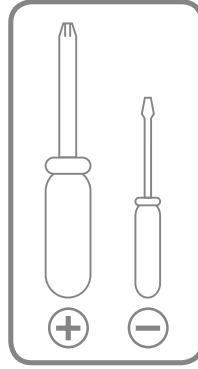
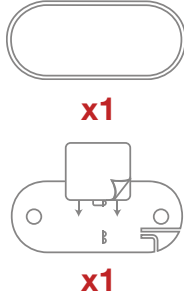
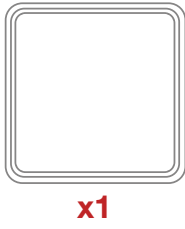

 Inhalt  Contenu  Inhoud  Sisältö
 Indhold  Contenido  Conteúdo  Περιεχόμενα  Innehåll

 Getting started  Erste Schritte  Démarrage  Aan de slag
 Αλφεισπας  Kom i gang  Operazioni preliminari  Para empezar
 Para começar  Πρώτα βήματα  Kom igång

GB Optional features 02 Optionale Funktionen 03 Options disponibles 04 Opties
 FI Valinnaiset ominaisuudet 05 Valgfrre funktioner 06 Funzionalità opzionali 07 Opciones disponibles
 PT Funções opcionais 08 Προαιρετικές λειτουργίες 09 Μόγιγια funktioner

	Hello	Ding Dong	Westminster	Marimba	Piano	Bell	Telephone	Soft Alert
04	•	•					•	•
05	•	•	•	•			•	•
06	•	•	•	•	•	•	•	•

12s
 x1
 x2
 x3
 x2
 3Hrs
 x3
 6Hrs
 x4
 9Hrs
 x5
 12Hrs



GB Trouble shooting 02 Fehlerbehebung 03 Dépannage 04 Probleemoplossing
 FI Vianmääritys 05 Problemløsning 06 Risoluzione die problemi 07 Solución de
 problemas 08 Resolução de problemas 09 Αντιμετώπιση προβλημάτων 10 Felsökning

livewell.honeywell.com



32305357-001 Rev.A